

ID-SPTCCT

Key Features

Mounting type: Recessed

Lm (up to): 540Lm

CRI: 80+

IP Rating: 65

Available In: 2700K - 6500K

Available beam angles: 60°

Warranty: 5 Years



TRIAC

>80
CRI

IP65

Mechanical Data

Cable Sheath MaterialPVC

LED Chip BrandMTC

LED Module ReplaceableNo

LED Chip TypeSMD 2835

Diffuser MaterialPC

Entry Cable DirectionBack

Product Weight180 g

Product Dimensionsundefinedxundefinedx45 mm

0161 507 9249 | support@ultraleds.co.uk | www.ultraleds.co.uk | Manchester, M17 1SJ Date: 08/07/2025

Ultra LEDs have taken reasonable care to ensure that the information in this datasheet is accurate at time of publication however it should be noted that all specifications are subject to tolerance. Descriptive specifications such as colour are subjective. Ultra LEDs reserve the right to update specifications without notice. The information in the datasheet may only be relied on by customers of Ultra LEDs in accordance with applicable terms and conditions

Dimensions

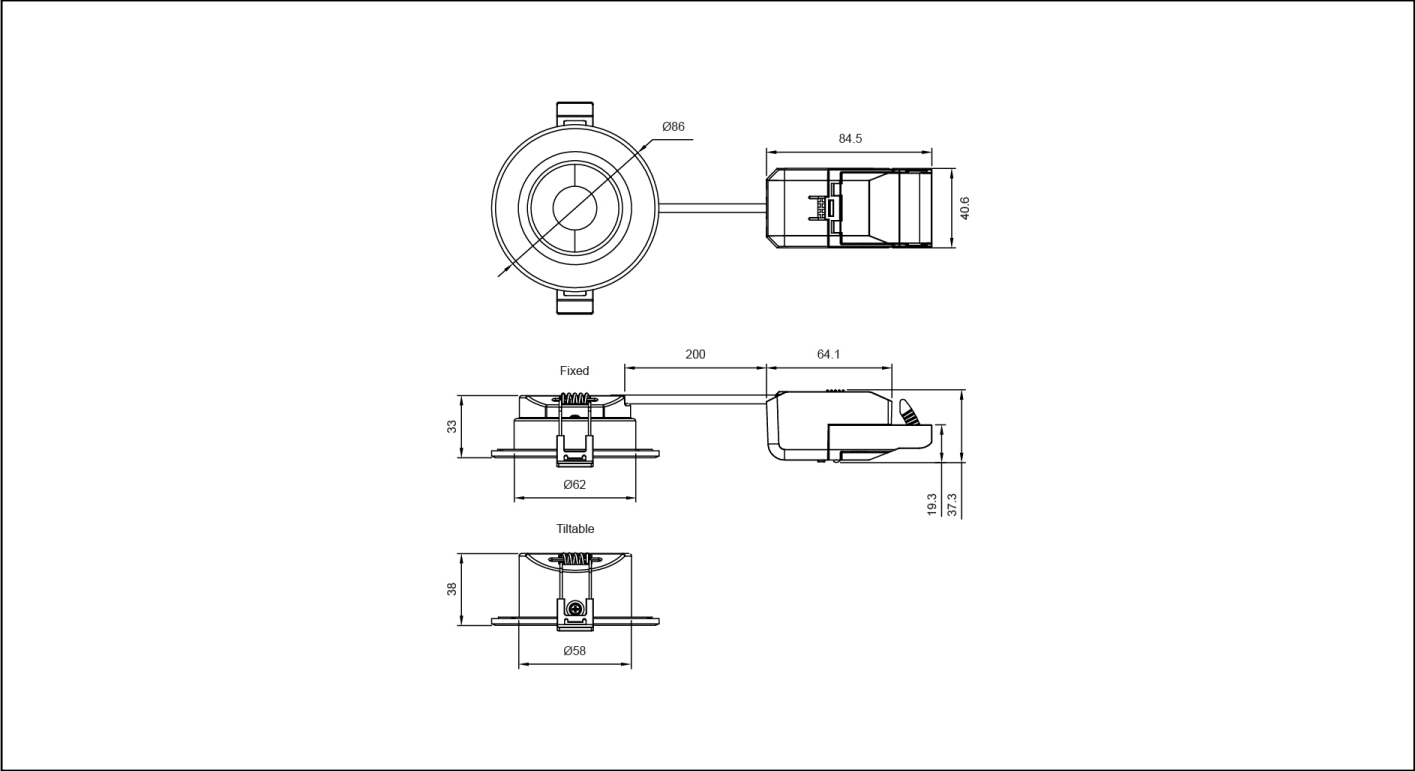

Input

Input Cable Length	250 mm
Input Cable Shape	Round
Input Cable Weight	20 AWG
Input Current	0.03 A
Displacement Factor	0.7
Power Factor	0.8 A
Input Cable Core Colours	Black, Brown, Blue
Input Frequency	50 - 60 Hz
Input Current Type	AC
Input Voltage	220 -240 V

Control

Dimming Type	TRIAC
--------------	-------

Dimming Range	5 - 100 %
---------------	-----------

Electrical Data

Constant Voltage / Constant Current	CC
-------------------------------------	----

Protection

Electrical Safety Class	II
-------------------------	----

Over Current Protection	Yes
-------------------------	-----

Over Temperature Protection	Yes
-----------------------------	-----

Short Circuit Protection	Yes
--------------------------	-----

Photometric Data

Lumens Per Watt	100 Lm/W
-----------------	----------

Peak Luminous Intensity	570 cd
-------------------------	--------

Beam Angle	60 °
------------	------

Colour Type	Single Colour
-------------	---------------

CRI	80
-----	----

Lumen Total	540 Lm
-------------	--------

SDCM	< 6
------	-----

CCT	2700 - 6500 K
-----	---------------

Environment

Body Material	Metal
---------------	-------

Ingress Protection (IP)	IP65
-------------------------	------

Mounting Type	Recessed
---------------	----------

Efficiency

L70B50	50000 Hours
--------	-------------

L80B10	35000 Hours
--------	-------------

0161 507 9249 | support@ultraleds.co.uk | www.ultraleds.co.uk | Manchester, M17 1SJ Date: 08/07/2025

Ultra LEDs have taken reasonable care to ensure that the information in this datasheet is accurate at time of publication however it should be noted that all specifications are subject to tolerance. Descriptive specifications such as colour are subjective. Ultra LEDs reserve the right to update specifications without notice. The information in the datasheet may only be relied on by customers of Ultra LEDs in accordance with applicable terms and conditions

L90B10	20000 Hours
Lumen Maintenance Factor	0.9
Rated Life	50000 Hours